

Patty Machine

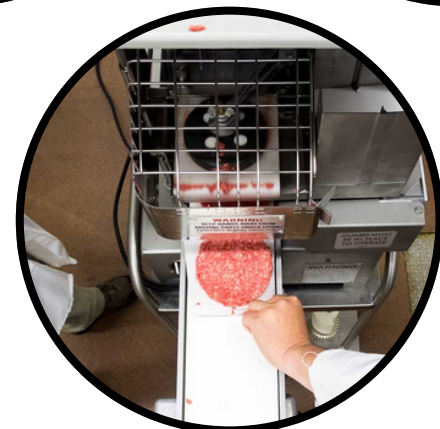

We have Hopper tops/bottoms, compressors, belts, hopper assemblies, and many more parts for Hollymatic Patty Machine.



This image is only for reference and not affiliated with manufacture.

Hollymatic Patty Machine

Super 54



HOLLYMATIC® Model 54 "Super" Patty Machine

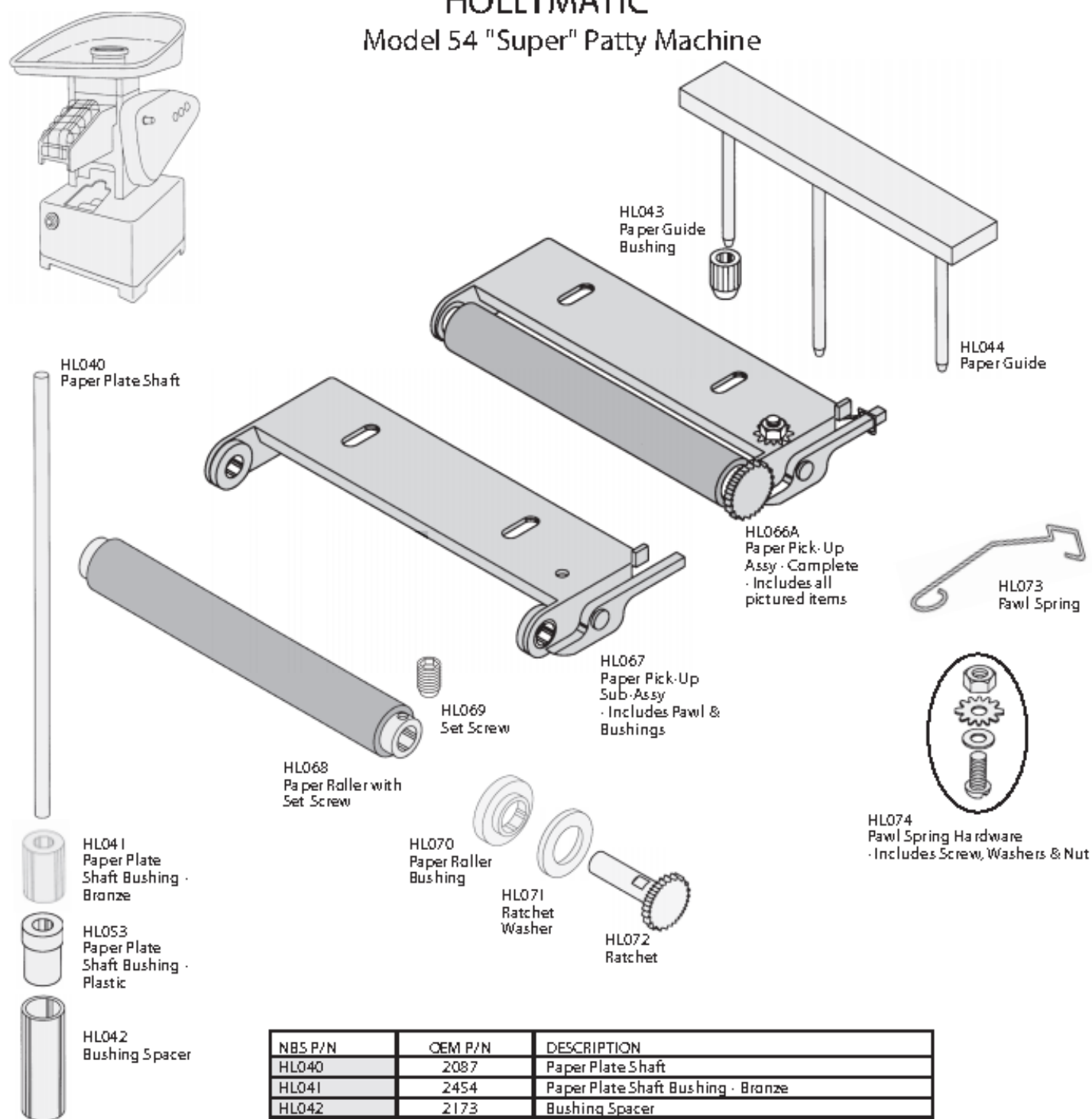

NBS P/N	OEM P/N	DESCRIPTION
HL040	2087	Paper Plate Shaft
HL041	2454	Paper Plate Shaft Bushing - Bronze
HL042	2173	Bushing Spacer
HL043	2072	Paper Guide Bushing
HL044	2210	Paper Guide
HL053	2454	Paper Plate Shaft Bushing - Plastic
HL066A	2377	Paper Pick-Up Roller Assy - Complete
HL067	2386	Paper Pick-Up Roller Sub-Assy
HL068	2380	Paper Roller with Set Screw
HL069	712-0140-99	Set Screw
HL070	2374	Paper Roller Bushing
HL071	2382	Ratchet Washer
HL072	2373	Ratchet
HL073	2384	Pawl Spring
HL074	2484	Pawl Spring Hardware

Hollymatic is a registered Trade Mark of the Hollymatic Corporation.
The above described parts are supplied by National Band Saw Company as replacement parts for Hollymatic® equipment.

HOLLYMATIC®

Model 54 "Super" Patty Machine

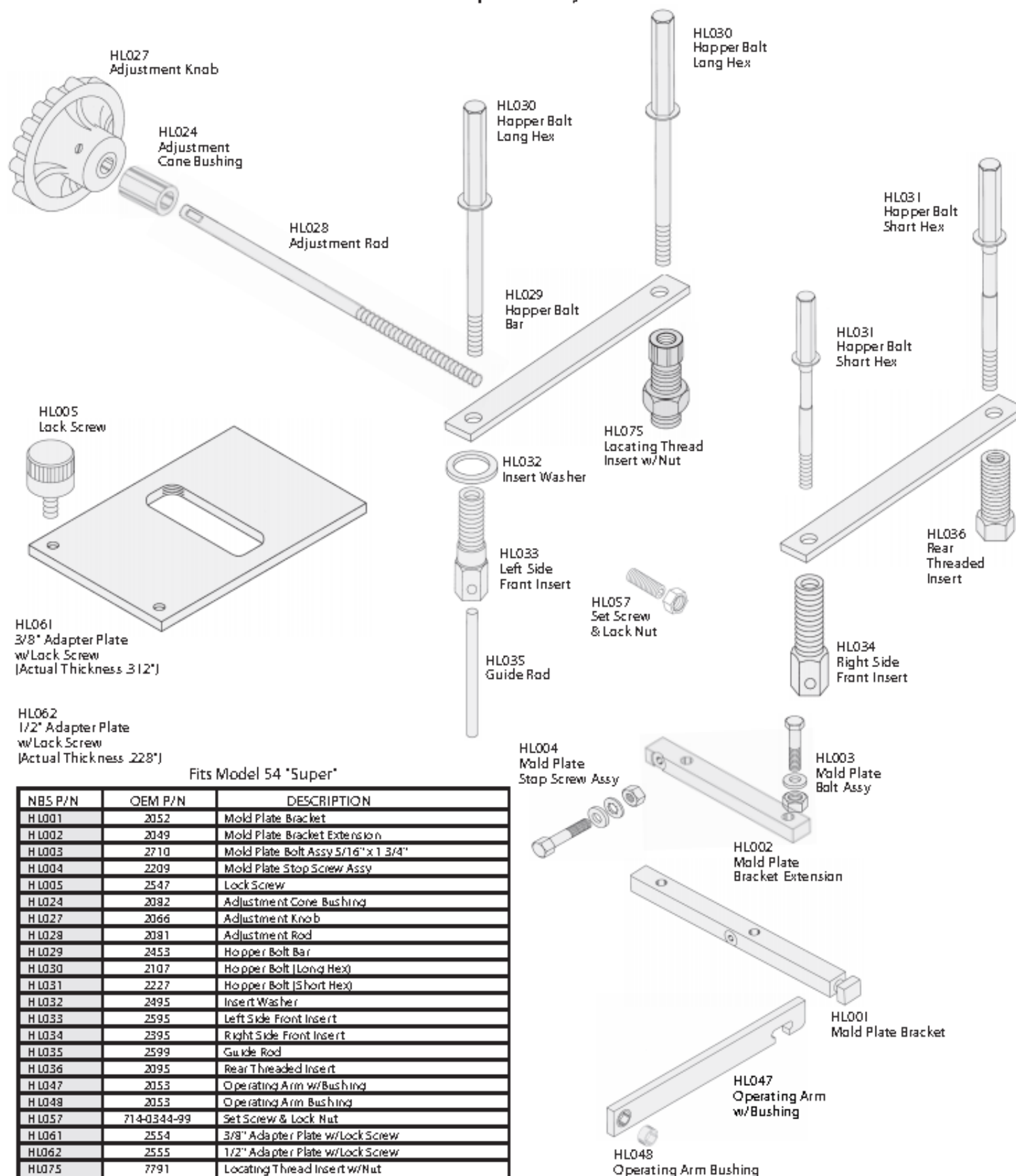

Fits Model 54 "Super"

NBS P/N	OEM P/N	DESCRIPTION
HL001	2052	Mold Plate Bracket
HL002	2049	Mold Plate Bracket Extension
HL003	2710	Mold Plate Bolt Assy 5/16" x 1 3/4"
HL004	2209	Mold Plate Stop Screw Assy
HL005	2547	Lock Screw
HL024	2082	Adjustment Cone Bushing
HL027	2066	Adjustment Knob
HL028	2081	Adjustment Rod
HL029	2453	Hopper Bolt Bar
HL030	2107	Hopper Bolt (Long Hex)
HL031	2227	Hopper Bolt (Short Hex)
HL032	2495	Insert Washer
HL033	2595	Left Side Front Insert
HL034	2395	Right Side Front Insert
HL035	2599	Guide Rod
HL036	2095	Rear Threaded Insert
HL047	2053	Operating Arm w/Bushing
HL048	2053	Operating Arm Bushing
HL057	714-0344-99	Set Screw & Lock Nut
HL061	2554	3/8" Adapter Plate w/Lock Screw
HL062	2555	1/2" Adapter Plate w/Lock Screw
HL075	7791	Locating Thread Insert w/Nut

Hollymatic is a registered Trade Mark of the Hollymatic Corporation.
The above described parts are supplied by National Band Saw Company as replacement parts for Hollymatic® equipment.

HOLLYMATIC®

Model 54 "Super" Patty Machine

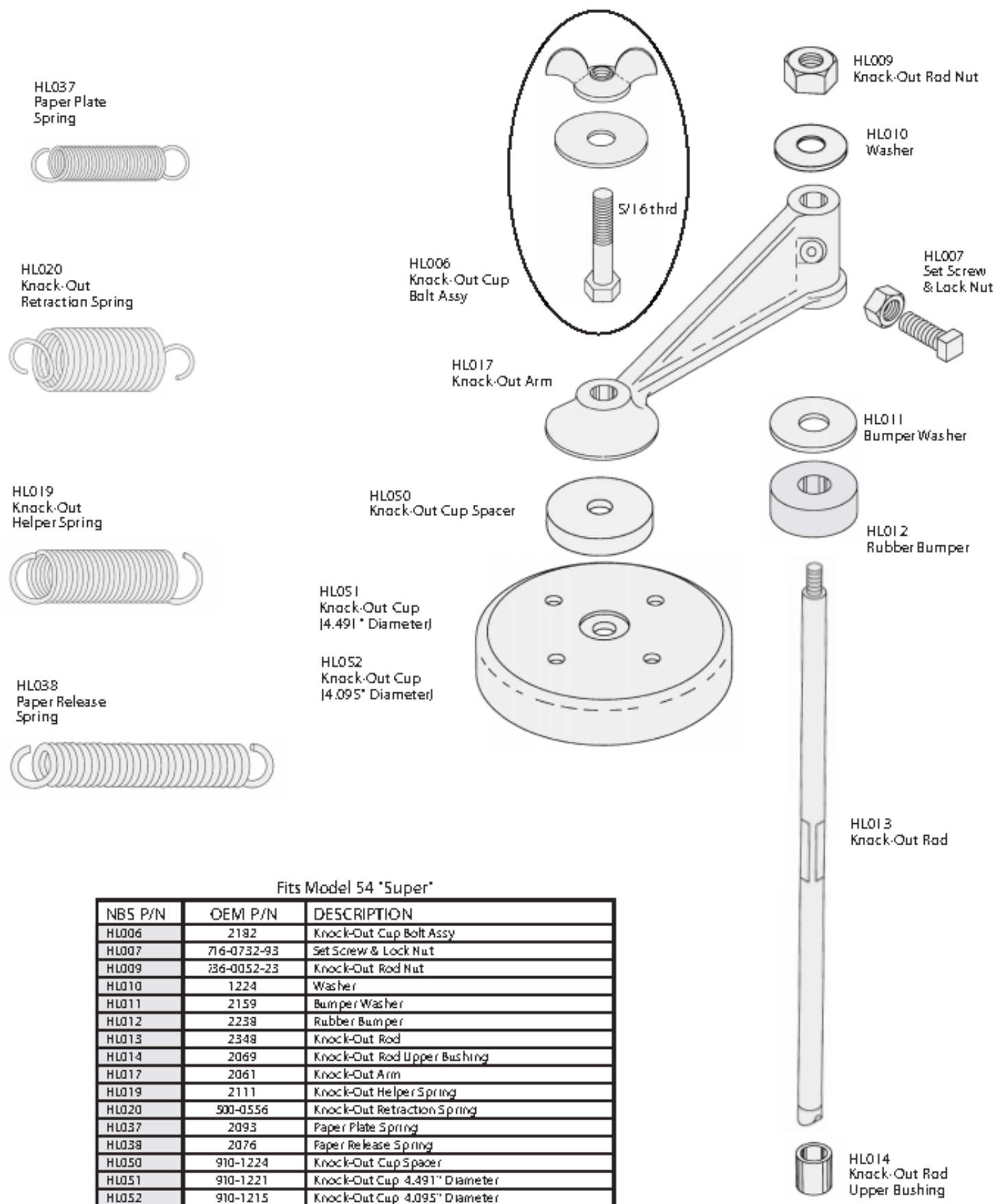

Hollymatic is a registered Trade Mark of the Hollymatic Corporation.

The above described parts are supplied by National Band Saw Company as replacement parts for Hollymatic® equipment.

HOLLYMATIC® Model 54 "Super" Patty Machine

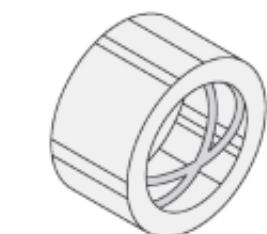

HL023
Main Shaft Bushing

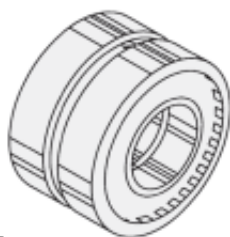

HL026
Main Shaft Bearing

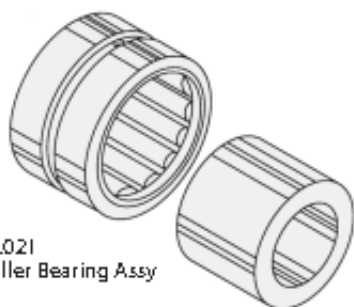

HL021
Roller Bearing Assy

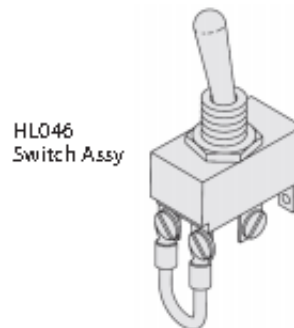

HL046
Switch Assy

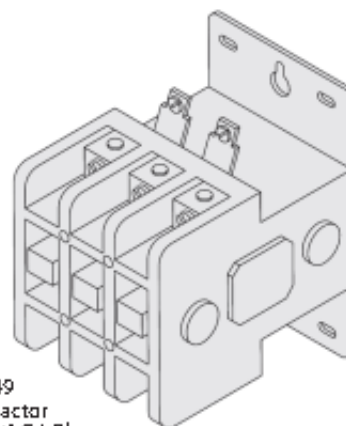

HL049
Contactor
110 VAC 1 Phase

Fits Model 54 "Super"

NBS P/N	OEM P/N	DESCRIPTION
HL021	2457	Roller Bearing Assy
HL023	2102	Main Shaft Bushing
HL026	2002	Main Shaft Bearing
HL046	7147	Switch Assy
HL049	7727	Contactor 110 VAC 1 Phase

BELTS

Drive Belt & Paper Feed Timing Belts

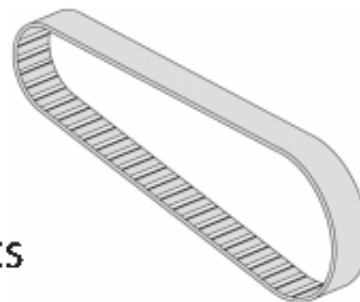

Fits Model 54 "Super"

NBS P/N	OEM P/N	DESCRIPTION	LENGTH
HL045	2161	Standard Drive Belt	L= 24"
HL076	7856	Paper Feed Belt, 95T, .08 Pitch	L= 7 5/8"
HL077	7860	Paper Feed Belt, 50T, .02 Pitch	L= 10"
HL078	7861	Paper Feed Belt, 75T, .02 Pitch	L= 15"
HL079	7862	Paper Feed Belt, 85T, .02 Pitch	L= 17 1/4"
HL080	7863	Paper Feed Belt, 55T, .02 Pitch	L= 11"

Hollymatic is a registered Trade Mark of the Hollymatic Corporation.

The above described parts are supplied by National Band Saw Company as replacement parts for Hollymatic® equipment.

Hopper Bottom

HL521



1 5/16" Height = 8 OZ.

HL524

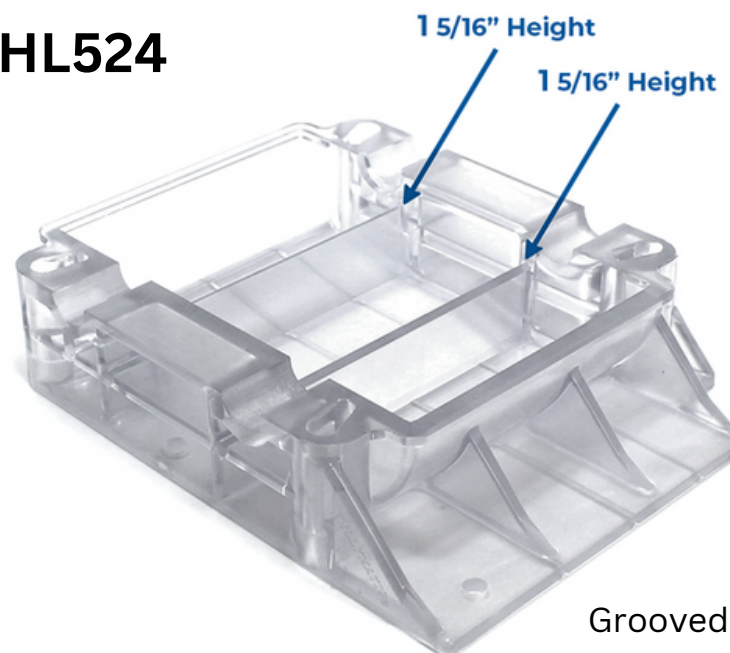

1 5/16" Height = 8 OZ.

HL520

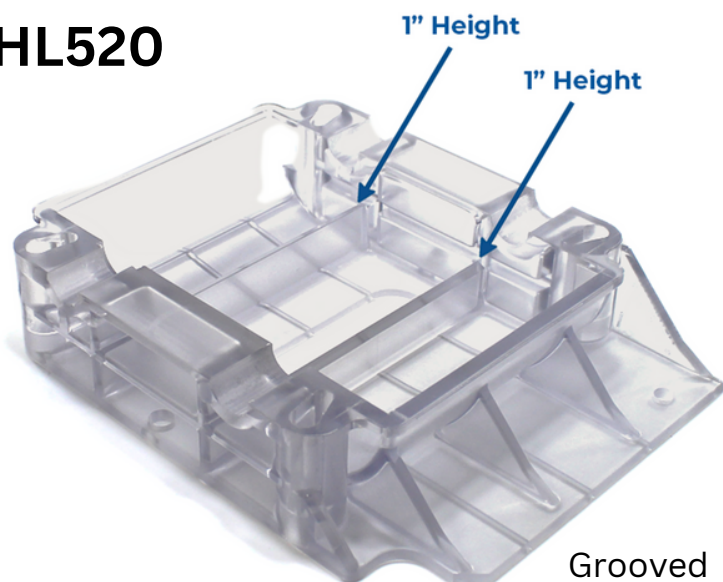

1" Height = 5 OZ.

HL519

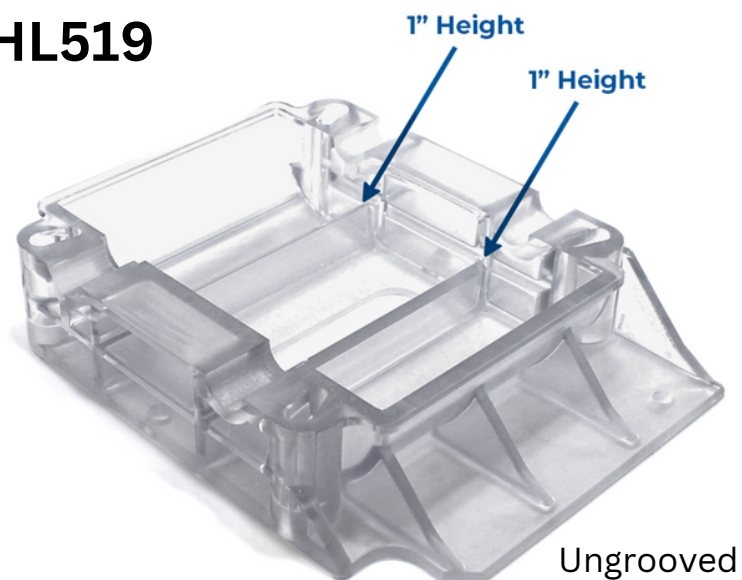

1" Height = 5 OZ.

Hopper Top

HL518

New Style



The Hollymatic patty machine with a hopper top is designed to streamline the patty-making process in commercial kitchens.

This innovative machine allows for easy loading of meat or other ingredients into the hopper, which then forms perfectly shaped patties with consistent thickness and weight.

With a durable construction and user-friendly design, the Hollymatic patty machine with a hopper top is a reliable and efficient solution for businesses looking to increase productivity and maintain quality in their food preparation.

Hollymatic® Patty Machine

Patty Machine

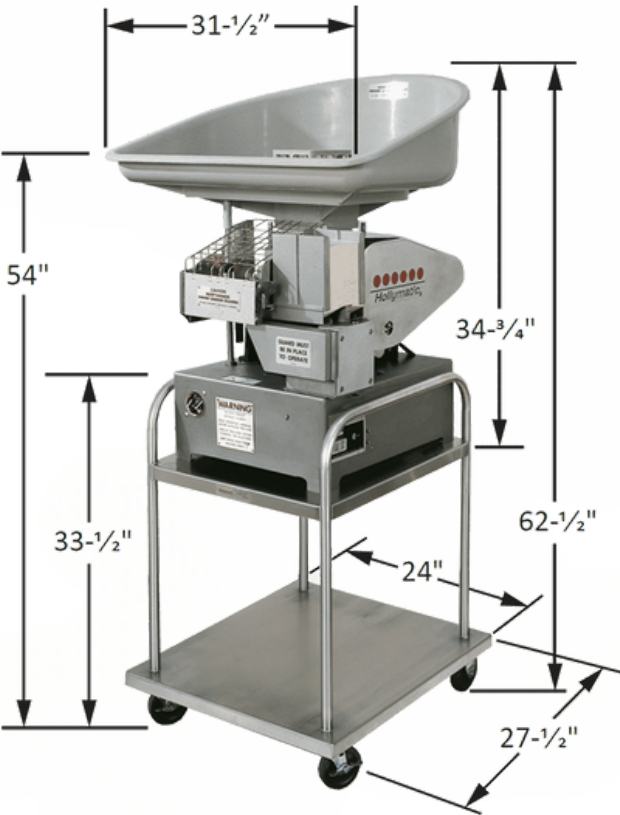

HL525



**NEW STYLE
HOPPER TOP**

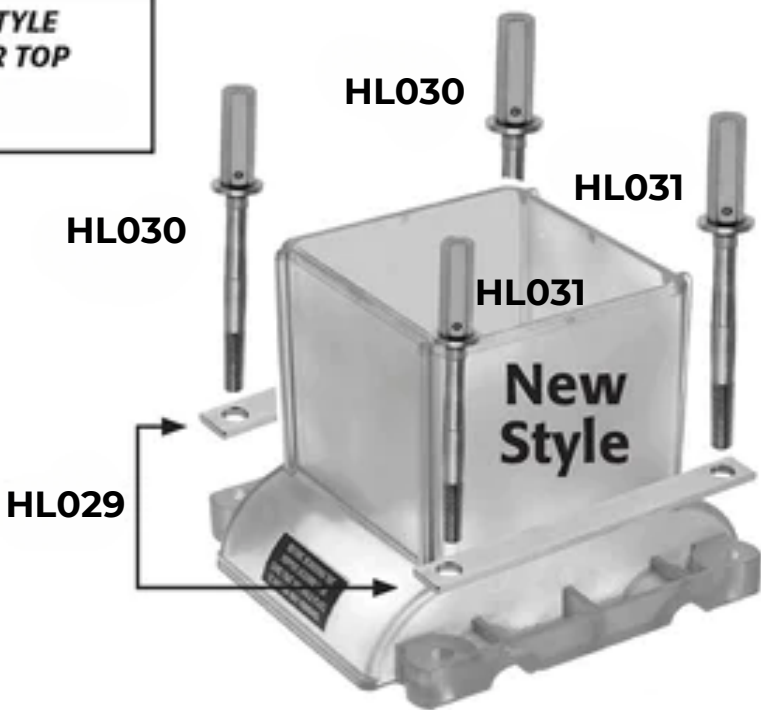

Super 54

COMPRESSORS

HL526 Front	5 Oz.
HL527 Rear	5 Oz.
HL522 Front	8 Oz.
HL523 Rear	8 Oz.

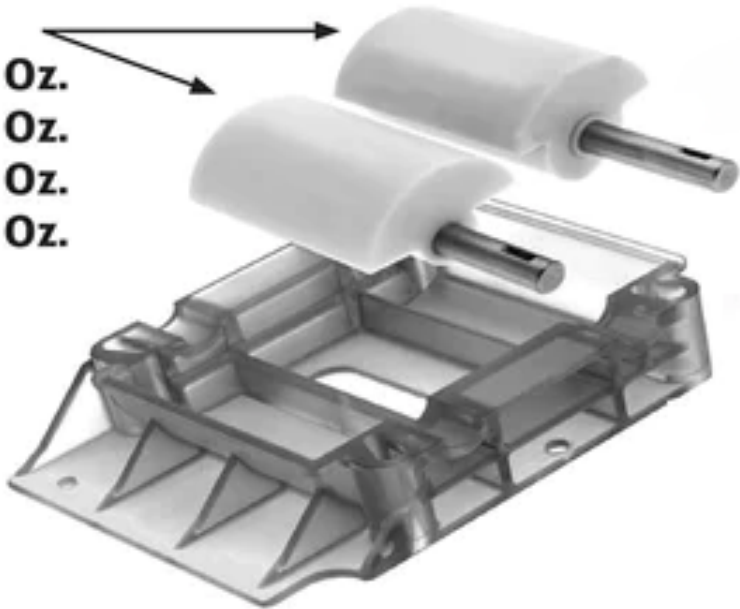

HOPPER BOTTOMS

HL519 - Clear	5 oz.
HL520- Clear (Grooved)	5 oz.
HL521 - Clear	8 oz.
HL524- Clear (Grooved)	8 oz.

*Hopper bottoms fit all Supers
including new current model.*

Hollymatic Patty Machine

What is a patty machine?

A patty machine is a specialized kitchen appliance designed to streamline the process of making patties or burger patties. It is commonly used in restaurants, fast food chains, and food processing facilities. The machine is equipped with a mold or plate that shapes the ground meat into uniform patties of a specific size and thickness. This ensures consistency in the size and shape of the patties, making them ideal for commercial food preparation. The patty machine is easy to use, efficient, and helps save time and effort in the patty-making process.

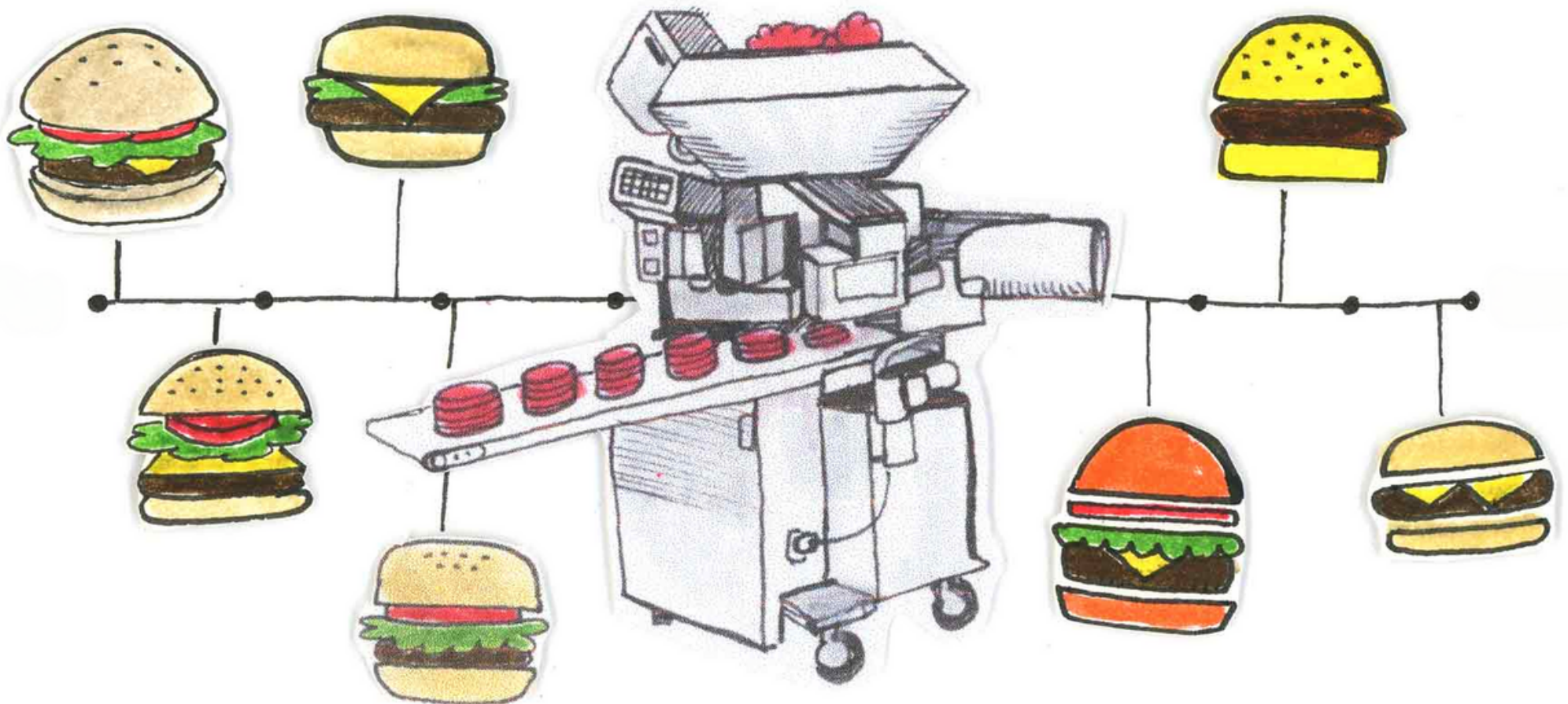



Hollymatic Super 54

The Hollymatic patty machine is a reliable and efficient solution for forming patties of up to 8oz with precise size, weight, and shape. With the ability to produce up to 2,100 patties per hour, this machine ensures consistent portion control for your food production needs. The automatic paper interleaving system adds convenience and efficiency to the process. Additionally, the mold plate changes are simple and fast, allowing for seamless transitions between different patty sizes. The stainless steel stand provides durability and hygiene, making it a valuable addition to any food processing operation.



Hollymatic Super Forming and Portioning Machine

FORMS AND PORTIONS A WIDE VARIETY OF PRODUCTS INCLUDING MEAT, POULTRY, SEAFOOD, VEGETABLES, BAKERY ITEMS AND MORE.

There's a good reason why the Hollymatic Super is found in more restaurants, supermarkets, drive-ins, small locker plants, and institutions than any other patty machine. The Super is an industry favorite for producing high quality patties. It's the most popular patty machine ever built.

- ▶ Forms patties up to 8 oz. in weight, from $\frac{1}{16}$ " to $\frac{1}{4}$ " thick. (1" optional)
- ▶ Exact and consistent size, weight, and shape.
- ▶ Produce up to 2,100 patties per hour with reliable portion control.
- ▶ Automatic paper interleaving system.
- ▶ Safety Interlocked.
- ▶ Mold plate changes, simple and fast.
- ▶ Fast, easy clean-up with one tool disassembly.

For more information contact Hollymatic or your local authorized Hollymatic Dealer today!



HOLLYMATIC SUPER MOLDS... A WIDE VARIETY TO CHOOSE FROM *



Optional 2' neoprene or wire mesh take away conveyor provides for continuous production. Equipped with a built-in digital programmable counter for accurate patty stacking.

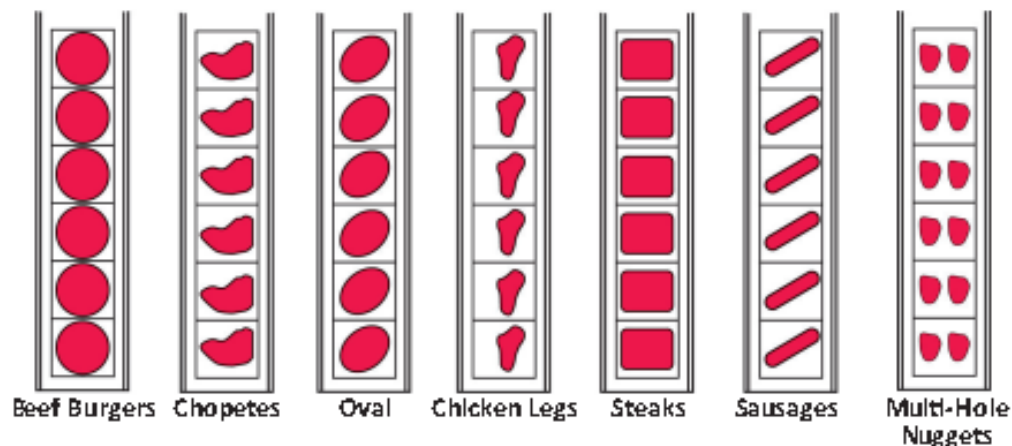

***Custom Shapes Available Upon Request**



AUTOMATIC PAPER FEED SYSTEM

Automatic paper interleaving system increases production capability. Paper can be added to the dispensing mechanism without the need to stop the machine.

STAINLESS STEEL STAND

A rugged, sturdy stand was created especially for use with the Hollymatic Super. All stainless steel construction gives you lightweight yet durable use. Built to keep your Super at proper, safe operating height. The easy-move stand gives you the maximum in roll-around convenience and flexibility.

**ALWAYS USE GENUINE
HOLLYMATIC PATTY PAPER**

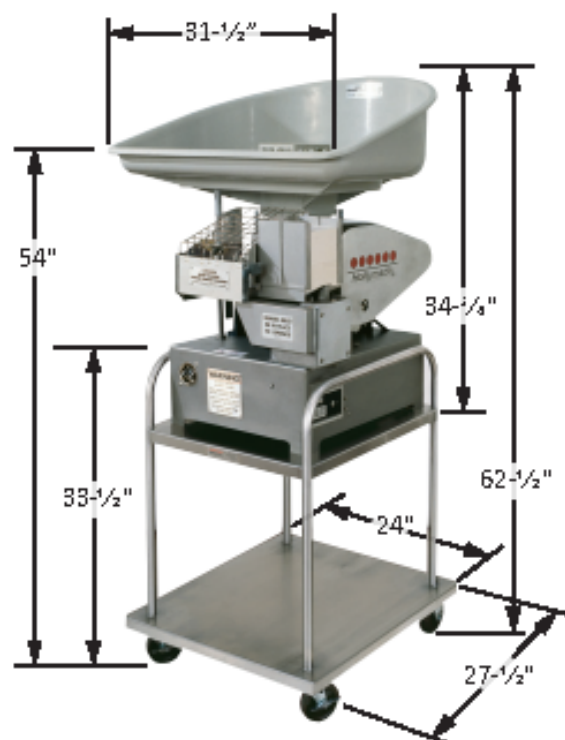

SPECIFICATIONS

MOTOR: 3/4 H.P 115/230 volt, 60Hz., 1 Ph. 12/6 A 115/220 volt, 50 Hz., 1 Ph. 12/6 A (3-Phase and other options available)

FEED TRAY: Removable and safety interlocked w/ guard.

PAPER FEED: 5 1/2" (standard) (automatic paper interleaving system). Optional 4-1/2", and 5" available.

SPEED: 2,100 or 1,800 portions per hour.

PORTION SIZE: Standard up to 8 ounces per portion.

MOLD PLATE:

Standard 1/8" to 1/4" thick. (1" thickness optional)

5 3/8" Maximum diameter with paper.

COMPRESSORS: 5 oz. or 8 oz., depending on portion size.

MACHINE STAND: Stainless steel with casters, custom built for the Hollymatic Super.

CONVEYOR: Optional 2' neoprene or wire mesh conveyor with digital programmable counter/stacker. Net weight of Super Conveyor: 31 lbs.

SUPPLIES: To maintain your Hollymatic Super in top condition, contact your local Authorized Dealer for genuine Hollymatic parts, supplies and quality Hollymatic patty paper.

NET WEIGHT: 330 pounds, including stand and mold plate.