

Meat Grinder



We have grinder knives, plates, rings, worms, stompers and many more parts for Biro grinder.

This image is only for reference and not affiliated with manufacture.



Ground Beef



Beef Patties



Grinder Ring

Sku#: B602

Grinder Plate

Lock Handle

Sku#: B621

Switch

Foot

Worm Assembly Components

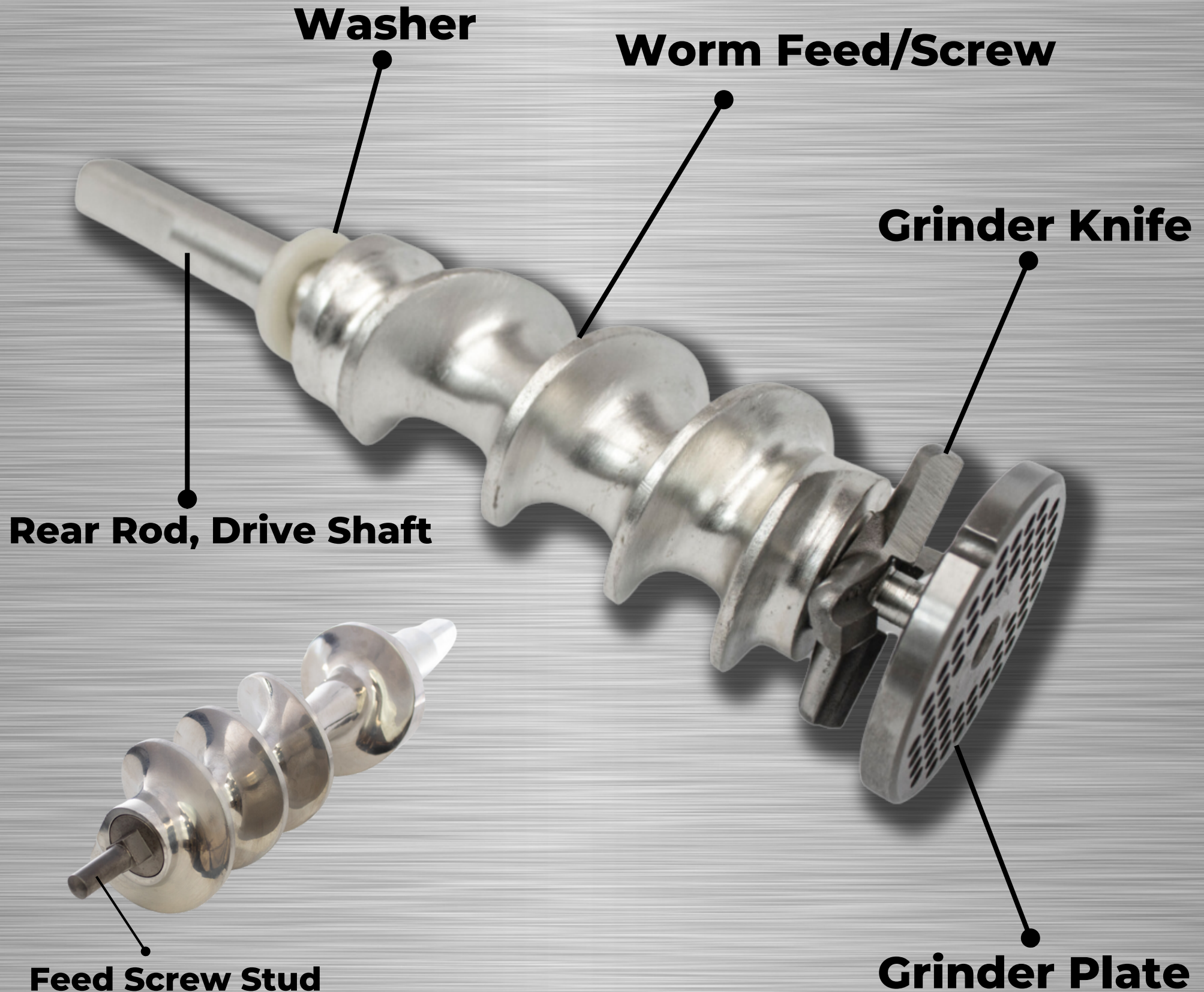

Worm/Feed Screw Sizes

Fits Biro Grinders

Sku#: B630A
Size 48



Sku#: B659A
Size 32

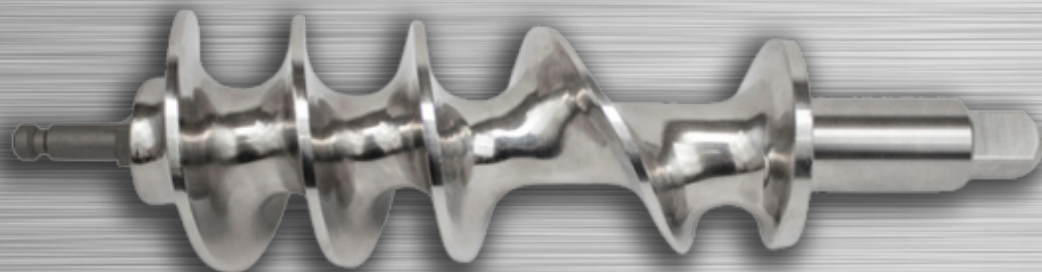

Sku#: B619A
Size 32



Sku#: B618A
Size 22



Sku#: B617A
Size 22



Sku#: B616A
Size 12



Stomper

The Meat Grinder stomper is an essential accessory for any meat grinder. The stomper is designed with a comfortable grip handle, allowing for easy and controlled operation.

Sku#: GR95, GR97, GR98



Spread Parts of Grinding Unit

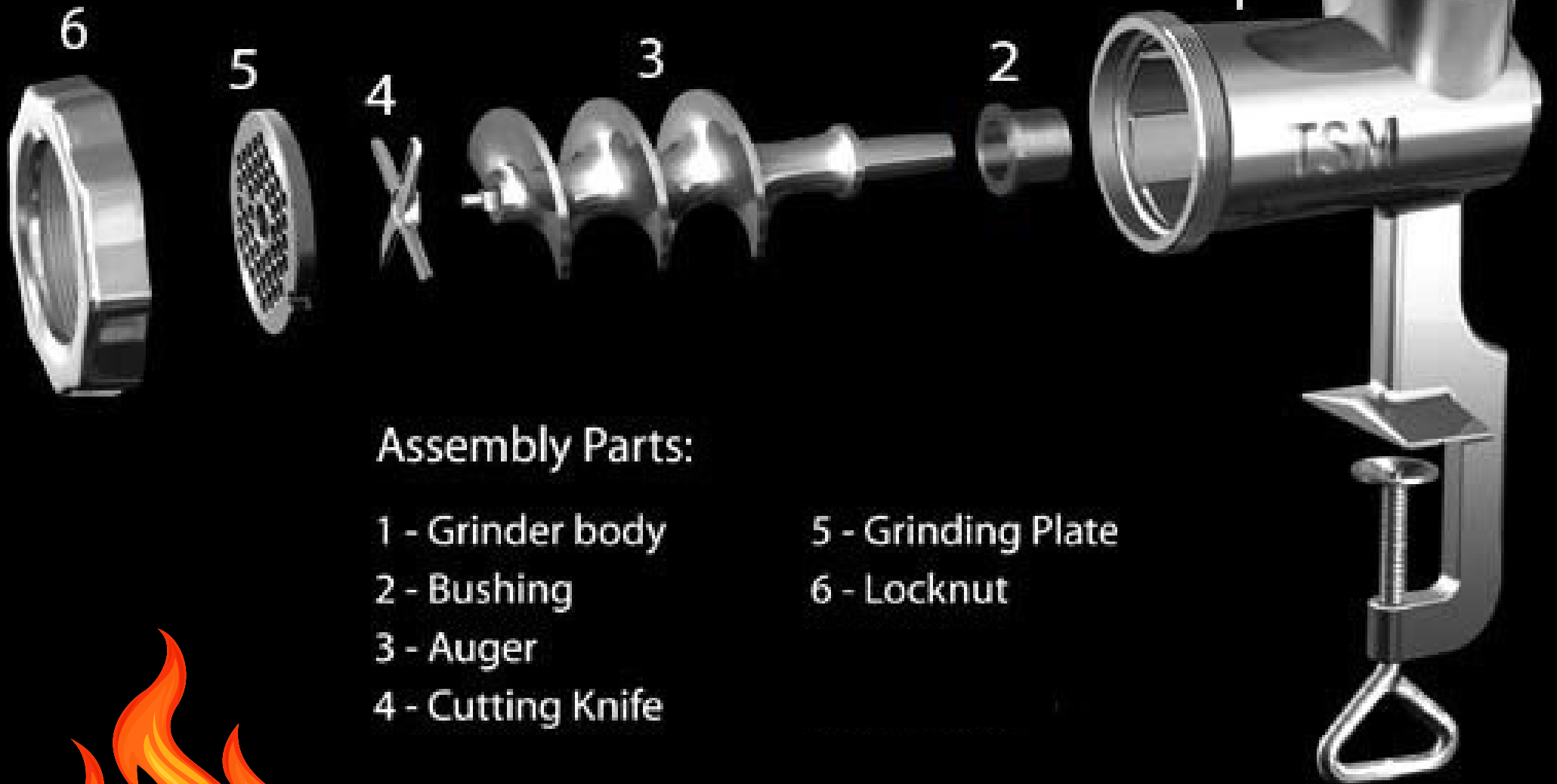

Assembly Parts:

1 - Grinder body

2 - Bushing

3 - Auger

4 - Cutting Knife

5 - Grinding Plate

6 - Locknut



Ground Meat



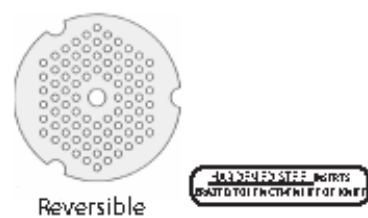
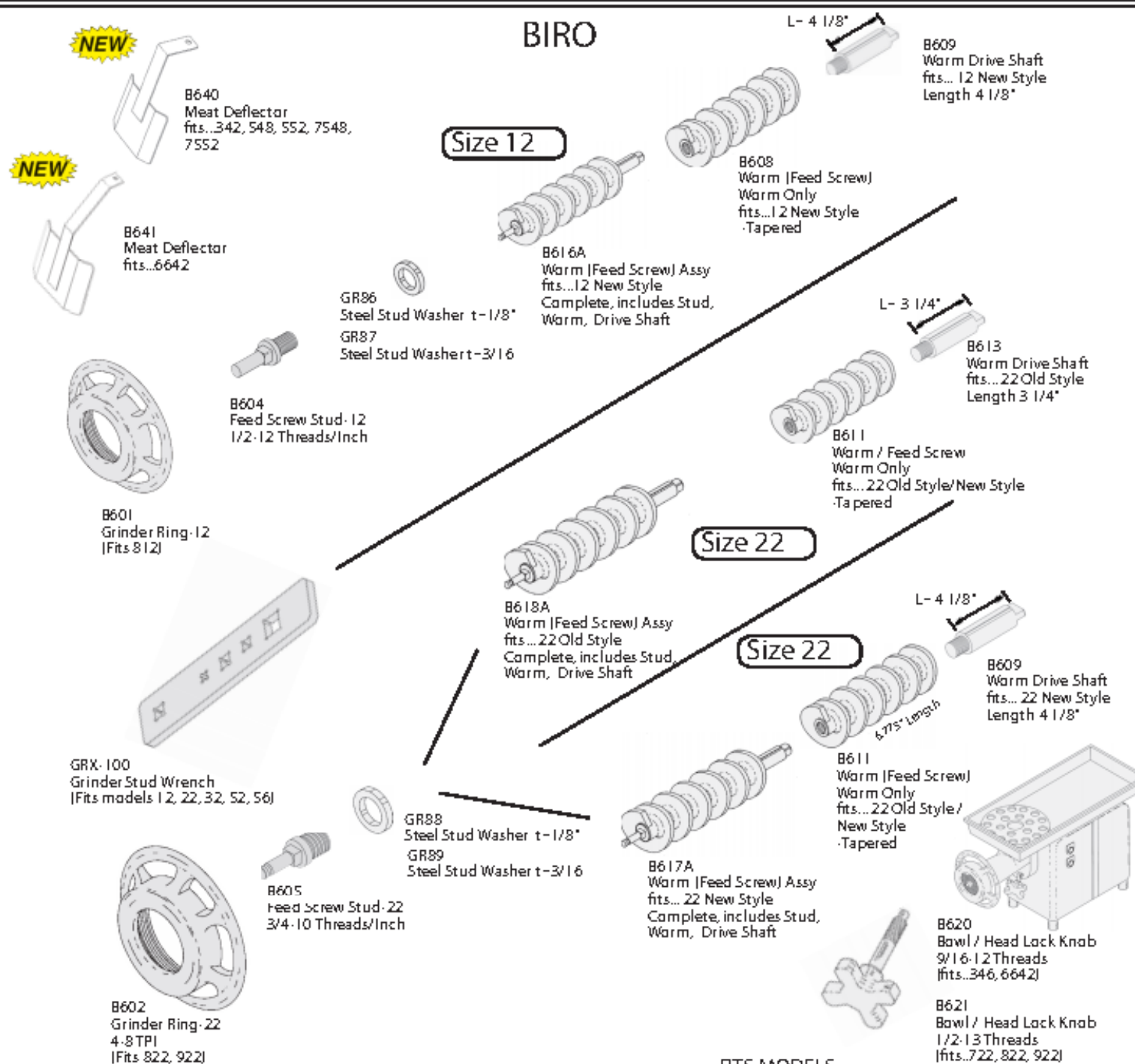

Don't Forget
your knives and
Plates:
GP12- or GP22-
for plates
GK12-5 & GK22-5
See Pages 6 & 8

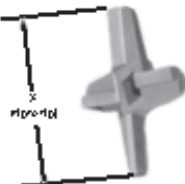

</

The above described parts are supplied by National Band Saw Company as replacement parts for Biro equipment.

BIRO

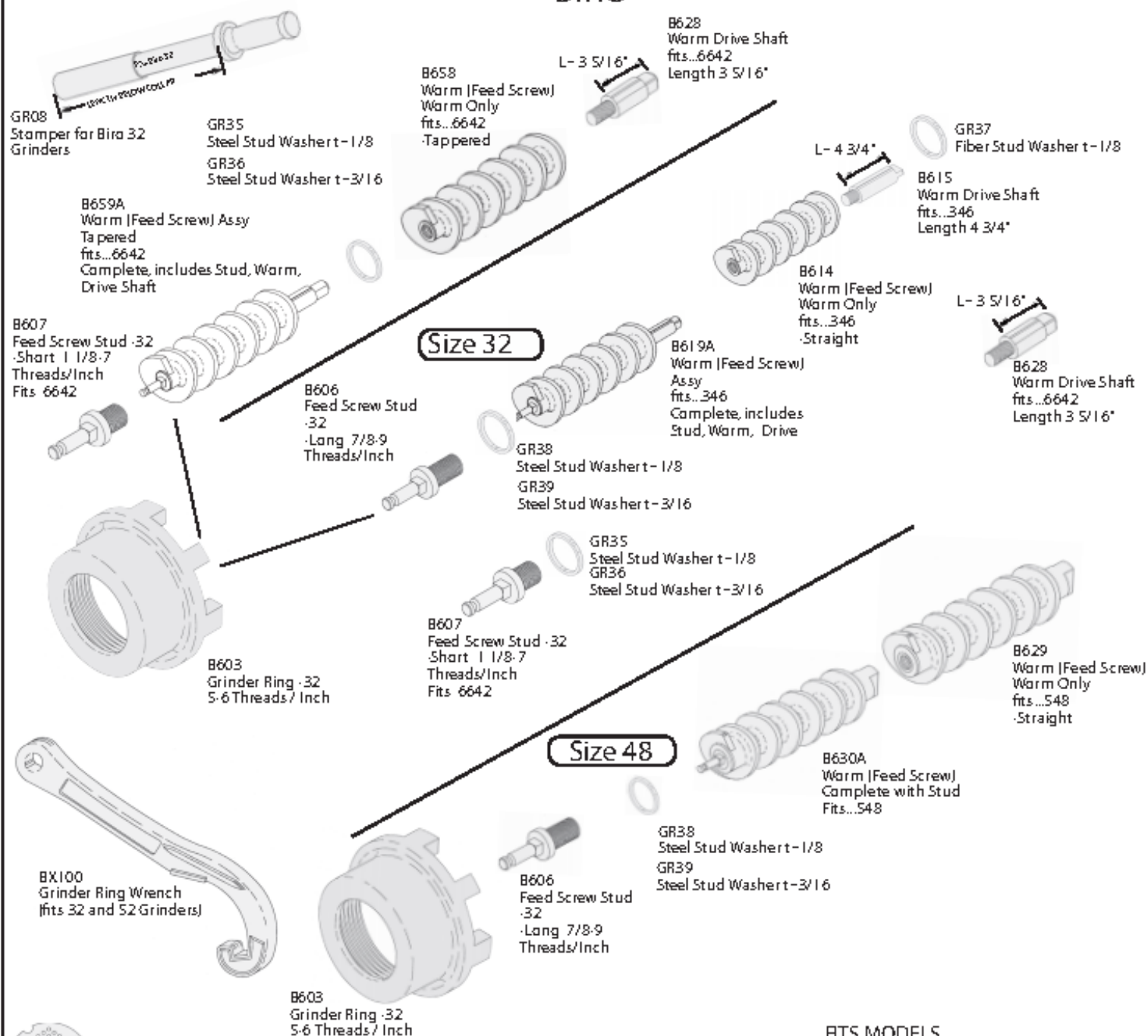

Reversible Plate.
See GP32
See Page 6



Steel Edge Knives:
See GK32-S, Page 8

ATS MODELS

[illegible]

The above described parts are supplied by National Band Saw Company as replacement parts for Bird equipment.

BIRO GRINDERS

Size 52



B610
Grinder Ring - 52
6 5/16-6 Threads / Inch
(Fits 552, 7552, AFMG52)



GR35
Steel Stud Washer t-1/8

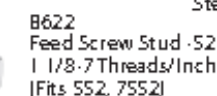

GR36
Steel Stud Washer t-3/16

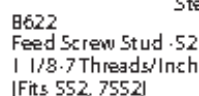

B622
Feed Screw Stud - 52
1 1/8-7 Threads/Inch
(Fits 552, 7552)



Reversible Plate:
See GPS2
See Page 6



Steel Edge Knives:
See GKS2-S, Page 8



BX100
Grinder Ring Wrench
(fits 32 and 52 Grinders)

SEALS

Transmission



B664
Seal
fits... AFMG-24
Transmission



B665
Seal
fits... AFMG-24



B666
Seal
Transmission
fits... AFMG-24

Front/Rear/Drive Shaft



B662
Seal
Front Shaft
fits... EMG32,



B663
Seal
Rear Shaft
fits... AFMG24



B667
Seal Shaft,



B668 Seal
Upper Shaft Seal



B670
Seal - Drive Shaft
fits... 342, 542, 548, 552,
7542, 7548, 7552, 1056, 1556

Motor



B669
Seal Motor,
fits... 6642



B671
Seal
Tub
fits... AFMG24

Auger Drive



B661
Seal - Auger Drive
AFMG-24, 48, 52
EMG 32, MINI 32
fits... 342, 542, 548, 552, 7542,
7548, 7552, 1056, 1556

RTS MODELS

RTS P/N	QEM P/N	DESCRIPTION	342	346	342	348	552	6642	7542	7548	7552	AFMG4811	AFMG32	EMG-32	AFMG-24	AFMG-48	AFMG-52	MINI 32	1056	1556
GR35		Steel Stud Washer t-1/8"					X	X			X		X							
GR36		Steel Stud Washer t-3/16"					X	X			X		X							
B610	HR52	Grinder Ring - 52					X				X		X	X						
B622	HR52/56	Feed Screw Stud - 52					X				X		X							
B661	HR42/48	Seal - Auger Drive	X		X	X	X		X	X	X			X	X	X	X	X	X	X
B662		Seal - Front Shaft												X	X					
B663		Seal - Rear Shaft					X	X			X		X							
B664		Seal - Transmission	X	X		X						X		X						
B665		Seal - Transmission	X	X		X					X		X							
B666	HR42/48	Seal - Transmission	X	X		X		X				X		X	X					
B667	HR48	Seal - Shaft, Front and Rear	X	X		X						X		X						
B668	42MC-16C2	Seal - Upper Shaft Seal						X												
B669	HR52	Seal - Motor					X				X		X							
B670	HR46	Seal - Drive Shaft	X		X	X	X		X	X	X							X	X	
B671	S3063	Seal - Motor Tub, AFMG Series													X					
BX100	HR40	Grinder Ring Wrench	X	X	X	X	X	X	X	X	X	X	X	X	X					

The above described parts are supplied by National Band Saw Company as replacement parts for Hobart equipment.

BIRO

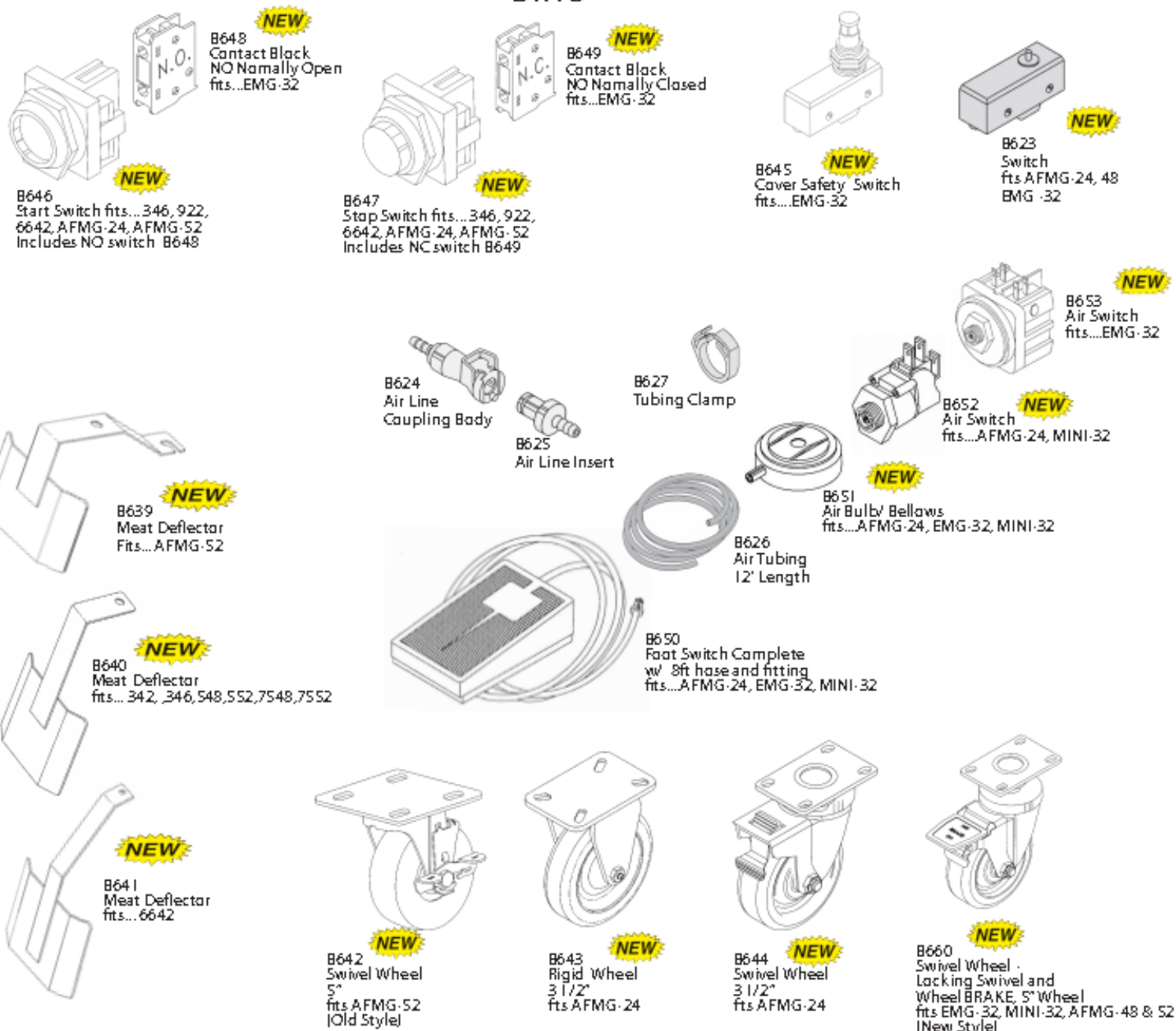

RTS MODELS

NBS P/N	CEM P/N	DESCRIPTION	342	346	548	552	6642	7552	AFMG-48-11	AFMG-52	EMG-32	AFMG-24	MINI-32
B623	53693-M	Switch							X		X	X	
B624	181-0316	Air Line Coupling Body								X	X		
B625	181-0317	Air Line Insert								X	X		
B626	563021	Air Line Tubing								X	X		
B627		Tubing Clamp								X			
B639	52392	Meat Deflector		X									
B640	H339-1	Meat Deflector											
B641	B42MC-Y90A	Meat Deflector		X									
B642	53952	Swivel Wheel 5"				X		X	X	X	X		X
B643	56139	Rigid Wheel 3 1/2"						X			X	X	
B644	56113	Swivel Wheel 3 1/2"							X	X	X		
B645	EMG90015	Cover Safety Switch								X	X		
B646	50768	Start Switch								X	X		
B647	50769	Stop Switch							X	X	X	X	
B648	EMG90194	Contact Block NO				X		X		X			
B649	EMG90180	Contact Block NC				X		X		X			
B650	56303, 5630	Foot Switch Complete						X			X	X	
B651	56300BEL	Air Bulb/ Bellows								X	X		
B652	56300D	Air Switch								X	X		
B653	563021	Air Switch								X	X		
B660	PC175-1	Swivel Wheel-Locking							X	X	X		X

The above described parts are supplied by National Band Saw Company as replacement parts for Biro equipment.

What Does A Meat Grinder Do?

Meat Being Grinded



Beef Patties



Ground Beef



The Meat Grinder is a versatile kitchen appliance that allows you to grind various types of meat effortlessly. With its powerful motor and sharp blades, it can quickly and efficiently grind meat to your desired consistency. Whether you want to make homemade sausages, burgers, or meatloaf, this grinder is perfect for any meat preparation task.

Butcher Boy Meat Grinder

Model: 722, 822SS, 922SS

The BIRO 722 / 822SS / 922SS Series of Manual Feed Grinders are reliable, durable, and affordable grinders perfect for restaurants, meat departments, and hunters. These grinders feature specially designed motors that provide ample power and output for all your grinding needs. Equipped with a single reduction HTD belt system, these grinders offer maximum power without slippage, ensuring greater productivity. The bowl assembly and feed tray can be easily removed without the need for tools, making cleaning and maintenance a breeze. With a 22 head size and the option of a straight or flared throat, you can choose the grinder that suits your specific requirements. Experience reliability, durability, and low maintenance with the BIRO 722 / 822SS / 922SS Series of Manual Feed Grinders.



The above described parts are manufactured and/or supplied by National Band Saw Company as replacement parts for equipment. National Band Saw is not affiliated with any original equipment or parts manufacturers.

